

ONE WALL. ONE SOLUTION.

One Wall, One Warranty, Endless Design possibilities.

Now part of Tremco Construction Products Group (CPG), Nudura® Insulated Concrete Forms (ICF) provides you the most user friendly system on the market with a single point of contact for a leak-free wall assembly.

One source for ICF forms, wall alignment system, waterproofing, sealants, flashings and window/door bucks. Allowing you to achieve a full ICF wall system, backed by the best warranty in the industry. Plus, with Nudura you get fast, local technical support that can assist and advise you on the job site, while also providing the largest Authorized Distributor network in North America.

Features & Benefits

- One warranty for full wall assembly
- Single source for ICF, wall alignment system, waterproofing, sealants, flashings, and window/door bucks
- Local technical support to assist/advise on job site
- Largest Distributor network in North America

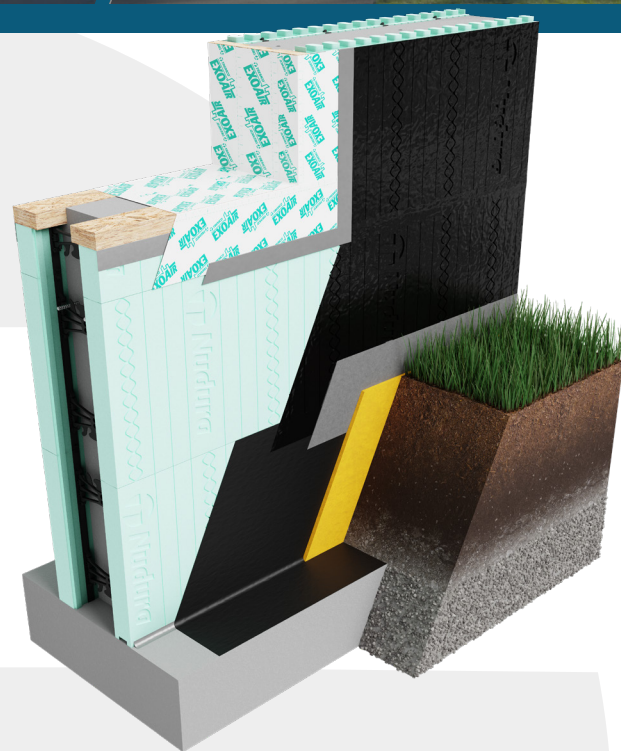

SCAN TO WATCH A ONE WALL
ONE SOLUTION PROJECT

ONE SOURCE PROVIDING SOLUTIONS

Waterproofing Solutions

Tremco's industry-leading below-grade waterproofing technologies ensure watertight, durable foundations. From roller/spray applied to peel & stick membranes, we have a waterproofing solution perfect for any project.



Flooring Insulation Solutions

If you are looking to have radiant heat in your next home, the Nudura HYDROFOAM maximizes radiant floor heating by ensuring the heat is dispersed evenly throughout the entire floor area. Easily cut to meet any angle or radius while providing up to R-16 (RSI 2.82, U-value 0.35) insulation value.



Sill Plate and, Window and Door Bucking Solutions

Prebuck sill plate, and window and door buck solutions offer the strongest, fastest, and smartest solutions available. Specifically designed for direct contact with concrete and non-corrosive to metals, Prebuck products feature TimberStrand Strandguard (LSL) engineered lumber treated with zinc borate for exceptional resistance to insects and decay. Prebuck products also feature MDI resin, the 100% waterproof bonding agent that turns to a durable plastic when cured.



Flashing Solutions

Tremco offers a complete product portfolio to meet any demanding job site condition. Such products include an impermeable, self-adhered roll membrane, as well as a durable, flexible sealant which both offer excellent performance in mitigating air infiltration/ex-filtration, vapor transmission and water penetration around window and door locations.



Weather Resistive Barrier Solutions*

Tremco weather resistive barrier (WRB) solutions deliver a more effective, permanent, and complete weather-resistant barrier than traditional house wrap products. Protects walls from liquid moisture in the form of rain, sleet, and snow.



Cladding Solutions

If you are looking for cladding solutions that bring new levels of protection to a formerly neglected area of foundation - from grade line to exterior finish. We offer a number of solutions that provide an aesthetically pleasing design with unmatched rugged durability.



Tremco Construction Products Group (CPG) brings together Tremco CPG Inc. and its Dryvit and Nudura brands; Willseal; Prebuck LLC; Tremco Barrier Solutions, Inc.; Weatherproofing Technologies, Inc. and its Pure Air Control Services and Canam Building Envelope Specialists offerings; and Weatherproofing Technologies Canada, Inc.



Nudura.com



Construction Products Group

3735 Green Rd. | Beachwood, OH 44122
800.321.7906 | tremcocpg.com