



# DESIGN & BUILD WITH NUDURA ICF

*All the benefits of ICF, no compromising on design*



# INTRODUCTION



## Nudura® ICFs are a proven method of providing you a better alternative to traditional building methods

Buildings today demand reliable, energy efficient and eco-friendly walls that provide superior performance to minimize energy costs, reduce carbon emissions and maximize property value. Structures made of Nudura® Insulated Concrete Forms (ICFs) offer superior strength, disaster resilience, sound and fire-resistance and energy efficiency. This is why the design community, developers, builders and contractors across the world continue to choose Nudura's ICFs and insulation products as a proven alternative to traditional building methods.

Nudura products provide the freedom and versatility to design and build projects the way they are envisioned. Designing and building with Nudura gives you the opportunity to build faster with more design flexibility, while offering an eco-friendly structure with substantial benefits that contribute to long-term energy savings. When choosing Nudura ICFs you can rest assured you have chosen the best building solution available today.

Nudura is now proudly part of Tremco Construction Products Group (CPG). A Tremco CPG single-source building envelope means more for everyone - more satisfied contractors, more comfortable occupants or tenants and more efficient structures and cost-effective operation for building owners.



*Go beyond your clients' expectations*

### At Nudura

We understand insulation is an essential component of every building project. Nudura is a leading manufacturer in energy efficient products and offers an extensive range of insulation products to meet your design requirements - the benefits are endless and so are the advantages.

### Our Goal

Our goal is to deliver more for your clients and to provide you with products that can do just that. Structures designed and built with Nudura offer:



Reduced monthly heating and cooling expenses  
-Reducing energy consumption by up to 58%\*



Withstand winds of up to 250 mph (400 kph)



Contribute to sustainability objectives



Greater occupant comfort



Continuous insulation, reducing energy loss



Reduced construction schedules

\*As proven by third party testing conducted by CLEB Laboratories and the Insulating Concrete Forms Manufacturers Association (ICFMA)

# THE ANATOMY OF BETTER BUILDING



## Structure Solutions

Insulated Concrete Forms (ICFs) are stay-in-place forms that offer you a variety of superior benefits when building your next project. Nudura ICFs are stacked, then steel reinforced and filled with concrete which completes the building envelope in one building step. With a full range of products to meet every insulation need, using Nudura will provide you with the an air tight, fully insulated building envelope with added benefits over traditional construction.

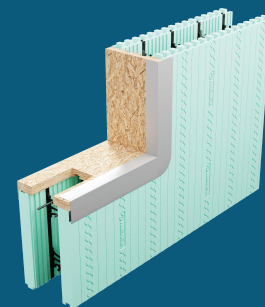

### 1 Nudura Standard Form

Nudura Standard Forms are 8' (96") in length, the largest standard block in the industry. Nudura's forms consists of two stay in place panels of Expanded Polystyrene (EPS) connected with our patented innovative hinged folding web.

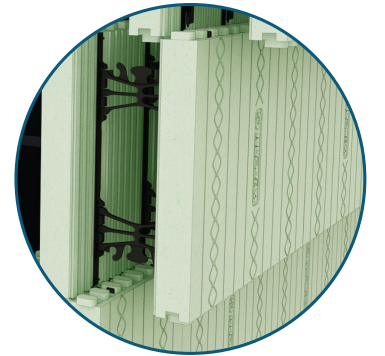

### 2 Nudura 90° Form

The 90° form is fully reversible, eliminating the need for different right and left corners. Nudura also offers a 45° form, a radius, a taper top and all of the accessories needed to ensure the envelope of any structure can be built with Nudura.

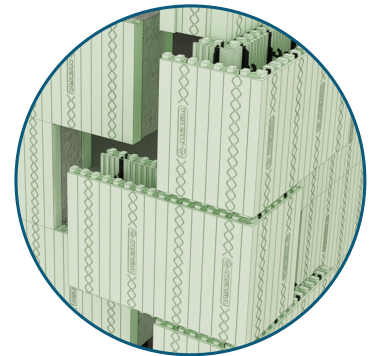

### 3 Nudura Optimizer

With the Optimizer form it is easy to optimize the height of any wall. Designed to be used as a height adjuster at the top of the wall, the Optimizer allows the installer the ability to hit 17 different stack heights from 4' (1220 mm) to 12' (3600 mm).

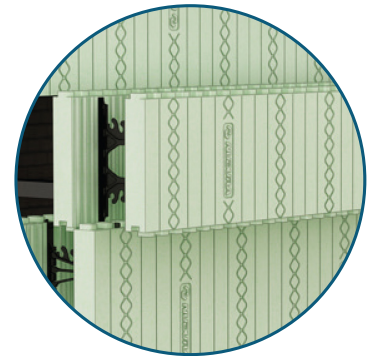

### 4 Nudura One Series

The One Series is ideal for elevator shafts, stairwells and other areas that require non-combustible material.

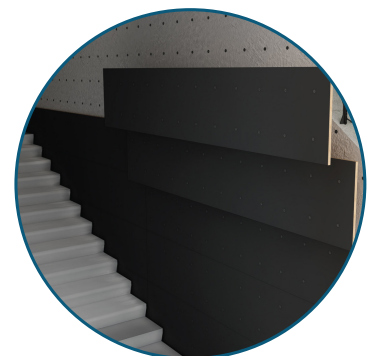

# PERFORMANCE BENEFITS WITH NUDURA ICFS

## Still specifying traditional building methods in your commercial designs?

When you and your team discuss products that are right for your next project, it is important to consider the value. We understand that value and can offer a team that help to get you through the decision process. Designing and building with Nudura and Tremco CPG has advantages over traditional construction.



Lower 1st cost



Structural design flexibility



Faster build time,  
quicker ROI



Competitive ICF  
installer market



Reduced weather-related delays



Simplified wall assembly,  
Mitigates failure risk



Reduction in sub  
& Reduced scheduling



Building code compliant  
throughout North America



Lower cost of ownership



Resilient/robust wall  
assembly (ICC500, FEMA &  
DOD Hardened Structure)



LEED & Sustainability,  
direct contribution



Tremco CPG companies  
offer the power of one:  
One building envelope.  
One Warranty.

## High-performance building solutions that fit your business.

We understand the needs and demands that face builders, architects and developers. Our products provide solutions to match the needs of the professionals who install, design and develop projects from residential to commercial. Our Insulated Concrete Forms and insulation systems combine design flexibility, efficiency and performance to create the ultimate building envelope solutions.

### Energy-efficient insulation

Confidently meet today's building code requirements while delivering an energy-efficient building with a full line of Nudura insulation products. Make your projects stand out with a quality insulation solution that performs consistently throughout the seasons without compromising on comfort, performance and efficiency for your clients.

Build an energy-efficient structure with insulation that works. Nudura offers a full range of Insulated Concrete Form products from our ICF Series which are manufactured with our installer in mind. Industry leading innovations get the walls up faster and easier. Our Integrated Series completes the building envelope, giving you the ability to completely insulate from footing to roof.

Most traditional insulation types can deliver only on R-Value. Nudura takes R-Value to the next level. The ICFMA (Insulated Concrete Form Manufacturers Association) Conducted testing with CLEB Laboratories to show that ICF walls can provide up to 58%\* better energy savings. How do they do that? The thermal mass of concrete combined with EPS Insulation makes building perform better compared to traditional products. Learn more about the CLEB report at [nudura.com/icf-performance](http://nudura.com/icf-performance).

\*As proven by third party testing conducted by CLEB laboratories and the Insulating Concrete Forms Manufacturers Association (ICFMA)

### Sustainable Designs

Nudura helps bring sustainable designs and Insulated Concrete Forms together. Projects specifying Nudura ICFs provide much greater potential for saving valuable environmental resources, reducing energy consumption and CO<sub>2</sub> emissions, two major factors facing today's commercial and residential buildings. From foundations to whole structures, Nudura has a complete library of solutions for your building design needs.



#### Richardsville Elementary

At 77,825 sq. ft. school located in Bowling Green, Kentucky sets the standards for being the first of its kind in the United States to utilize Nudura ICFs to achieve Net-Zero! Richardsville Elementary has a high-performance building envelope in conjunction with the solar panels on the roof, allowing them to harvest enough energy to offset the total energy consumed by the school, sending 300 kw of power back into the grid.

# Get in touch with a distributor near you!

## Next Step

The next step to building your Nudura project is to contact a Trained Nudura Installer (contractor) through a local Authorized Nudura Distributor. Nudura distributors provide extensive technical support and service, installation recommendations to maximize efficiency and cost savings, and provide current code compliance advice for local, regional, and national building codes. Visit [nudura.com](http://nudura.com) to locate a distributor in your area.

## Online Tools & Resources

Nudura makes the design process as easy and efficient as possible. Our website provides valuable design tools and resources for you and your architects, contractors, and design professionals. Our network of Authorized Nudura Distributors can also provide industry leading technical support.

---

[nudura.com](http://nudura.com)

## Distributed By:



The information contained in this Nudura® brochure is presented only for the purpose of providing information on the various products composing the Nudura Integrated Building Technology and any associated accessories (the "Nudura Products"), as well as affiliated Tremco Construction Products Group brands. This Brochure should not be used as a substitute for professional engineering consultation. Nudura makes no general warranties to the specific applicability of any of the Nudura Products to any or all situations for which a designer may elect their specific use. Final amendment or modification to suit the exact circumstance of employment of the Nudura Products is the responsibility of the project designer. Nudura does not have any control over the workmanship used in the assembly or installation of the Nudura Products.

Follow us on: Social media icons for Instagram, Twitter, Facebook, LinkedIn, and YouTube.

